

## floor drain DallDrain Select, DN 50, 120 x 120 mm

Part number: 517036

GTIN: 4001636517036

Rebate group: 6

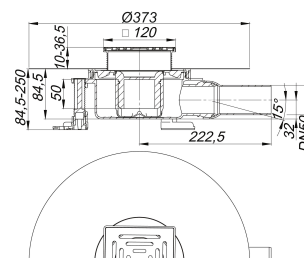

### Description:

floor drain DallDrain Select, DN 50, 120 x 120 mm

conforming to DIN EN 1253

Floor drain including grating DallDrain Select with stainless steel grate in stainless steel frame. Side outlet DN 50, with ball joint, adjustable from 0 – 15 degrees.

### Specification

- Stainless steel grate and frame
- Integrated screed anchoring
- Flexible, click-in sealing sleeve for secure connection to bonded and sheet waterproofing conforming to DIN 18534
- Fully removable, two-piece trap insert and rodding eye, 50 mm water seal (conforming to DIN EN 1253)
- Temporary blanking plate
- Three sound-insulated mounting feet for fixing and height adjustment 85 – 250 mm
- Spigot can be shortened for floorings 10 – 36 mm (including adhesive)

### Material

Polypropylene drain body and outlet, highly impact-resistant; 1.4301 stainless steel grate, load class K 3 (300 kg); spigot in ABS, frame in 1.4301 stainless steel

Pre-assembled set consisting of parts no. 517296 + 517210 + 517340.

Grating with positioning aid laterally adjustable +/- 9.5 mm.

Can be used with sound insulation mat DallDrain (part no. 517326) and

mounting aid DallDrain (part no. 517319).

### Spare parts:

501080 grate E 115, 115 x 115 mm

517296 grating DallDrain Select, 120 x 120 mm

517340 mounting feet DallDrain

517357 trap insert DallDrain

517197 sealing sleeve DallDrain